

## Door Frame Profiles

### DOORFRAME

**Technical features**

- For doors of 8, 10 and 12 mm. thick toughened glass
- For fixed panels of 8, 10, 12 and 15 mm
- Profile allowing several different hinges
- Compatible with lock series LUMIRA, LUMIRA vertical, BASTILLE, LAGUNE
- A blocking roller keep can be installed so handles or door knobs can be used
- Possible installation of an electric release keep (see chapter access control)
- Allows an easy integration of a glass door in a Securit set
- Use KL001 and KL002 profiles recommended to fix the frames

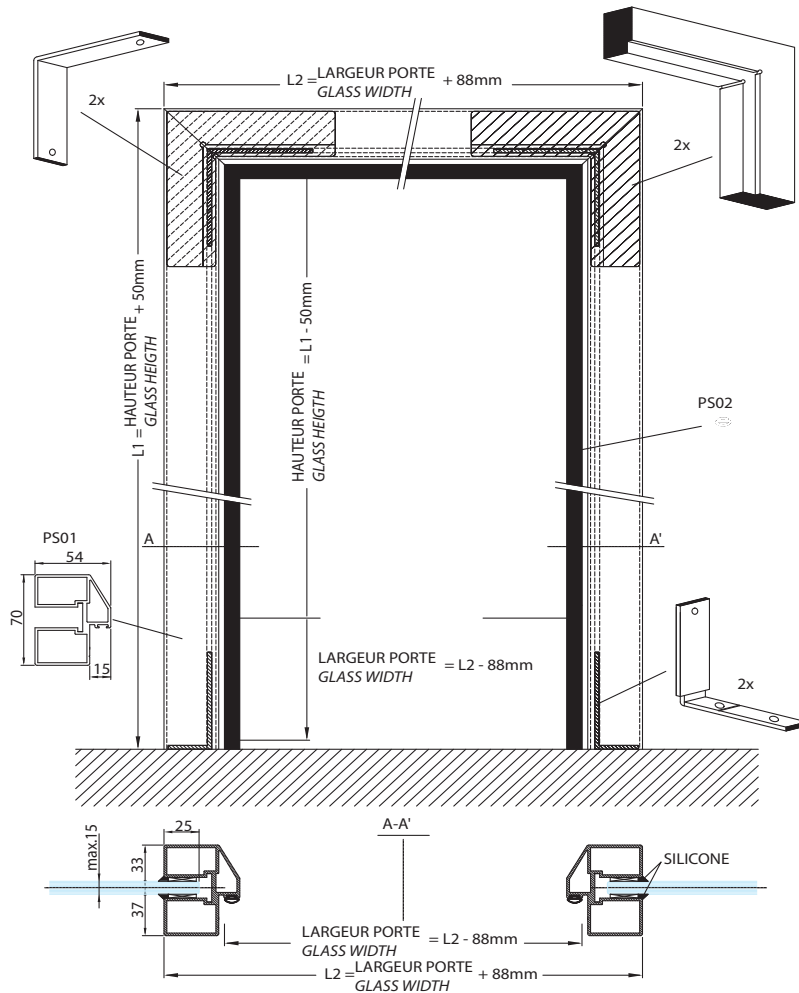



### PS01MST

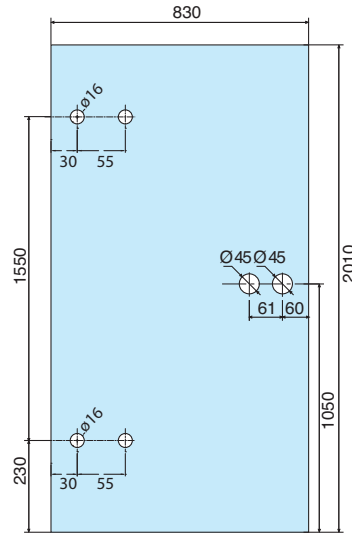

**References**



Complete Kit door frame profile for 830 x 2010 mm glass doors with lock V525 and hinges V504



Brushed anodised alu silver

**PS01MST.12**



Brushed anodised alu.

**PS01MST.36**

### PS

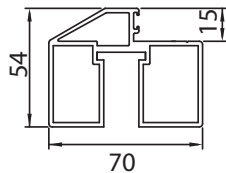

**References**



2500 mm length profile for vertical door frame



Brushed anodised alu silver

**PS2500.12**



Brushed anodised alu.

**PS2500.36**

1500 mm length profile for horizontal door frame

**PS1500.12**

**PS1500.36**

### PS02.99



**References**

Rubber strip for door frame

### PS09.99

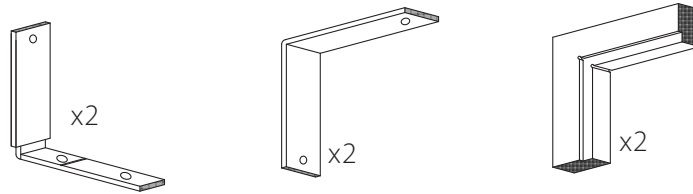

Corner mounting kit for doorframe profil PS01, including fixing screws

### V504

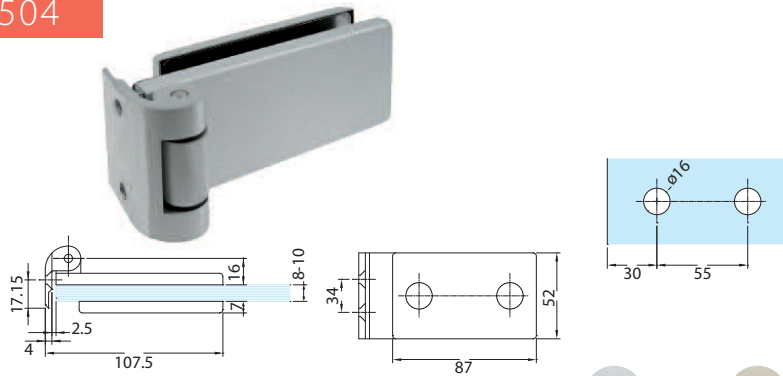

References

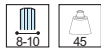

Brushed anodised alu silver

Brushed anodised alu.

Hinge and multi rebate butt for door frame aluminium profile for glass door PS01

V504.12

V504.36

### RS02.99

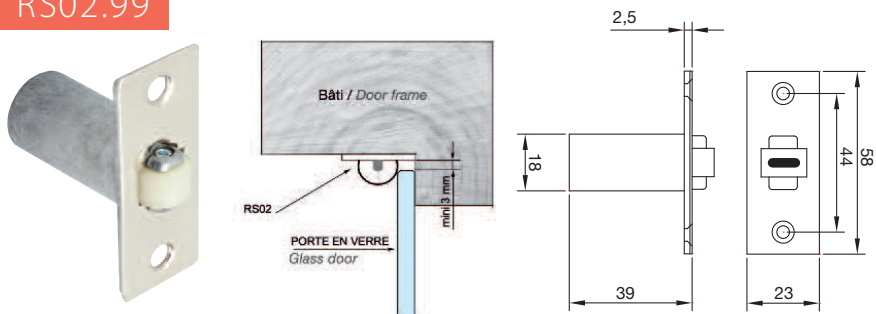

Blocking roller keep, adjustable

2800.66.\*

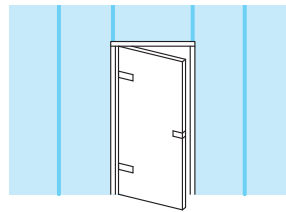
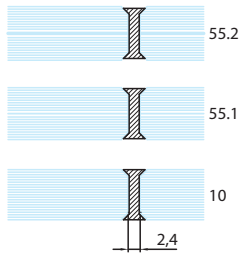
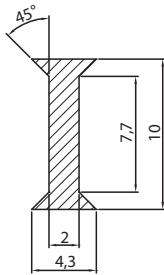

References

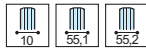

Dry glazing profile for glass 10 mm - 55,1 - 55,2 including tape for jointing 2 fixed panels

**2800.66.1**    **2800.66.0**

• Sold in units : packed by 10

2802.66.\*

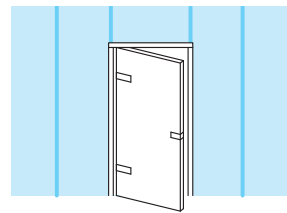
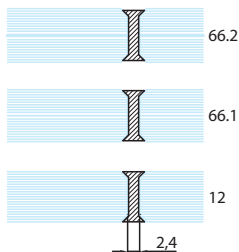
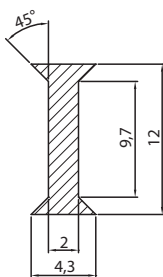

References

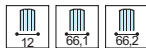

Dry glazing profile for glass 12 mm - 66,1 - 66,2 including tape for jointing 2 fixed panels

**2802.66.1**    **2802.66.0**

• Sold in units : packed by 10

