

Glass Door Closer - Floor & Overhead Closers

Door closer for glass door

Technical features

- Adjustable force EN 2-5 (16-38 Nm)
- Cast iron body and cover ABS
- Integrated hold open device easily adjustable to the desired angle
- Adjustment closing speed and final latch
- How to set the closing force: the mounting location and the attachment U-plate position determine the closing forces 2 – 3 – 4 – 5

564AC220.99

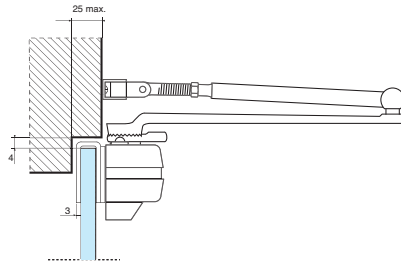
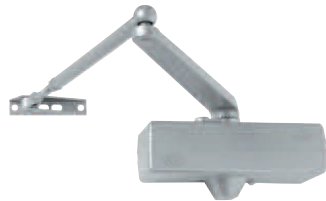

Door closer with hold open for tempered glass doors

AC220.25.73

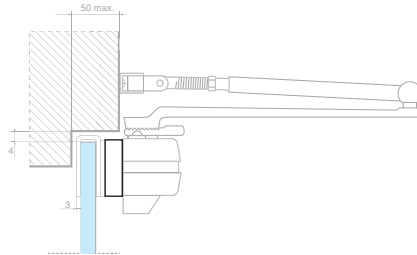
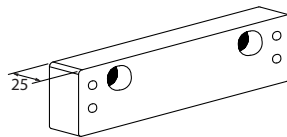

Filler for 564AC220

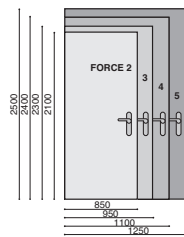

Closing speed adjustment (180°-10°).

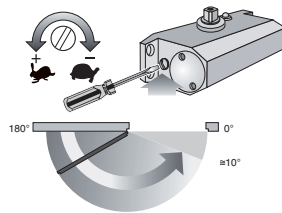

Adjustment of final latch angle (10°-0°).

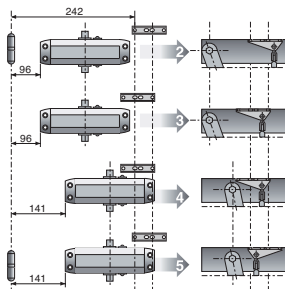
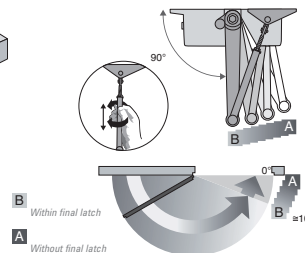

| Force | Max door width | EN requires | Mod. 564AC220 |
|-------|----------------|-------------|---------------|
| 2 | 850 mm | ≥ 13 Nm | ≥ 16 Nm |
| 3 | 950 mm | ≥ 18 Nm | ≥ 20 Nm |
| 4 | 1100 mm | ≥ 26 Nm | ≥ 30 Nm |
| 5 | 1250 mm | ≥ 37 Nm | ≥ 40 Nm |