

## Bastille - Locksets

### BASTILLE

#### Technical features

- For 8 -10 and 12 mm thick toughened glass
- To fit notch 6300EX
- Reversible
- European profile cylinder (DIN standard 18254)
- With cylinder covers
- Return of the latch bolt by key
- Locked with forward motion of latch bolt
- Possibility of combinations with master key
- Supplied with flat keep and 3 keys

- **Offset mechanism to allow compression of rebate strip.**



4501

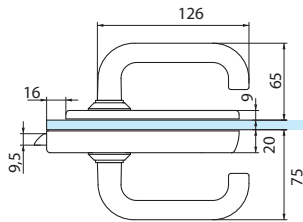
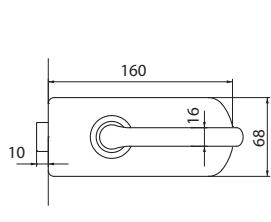
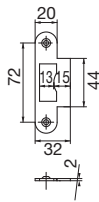
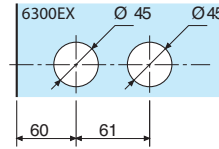

References



Polished brass PVD

Bright chromium

Matt chromium

Stainless steel effect

Lacquered white RAL 9010

4501.05.0

4501.30.0

4501.31.0

4501.35.0

4501.51.0

Latch set with pair of handles

4550.\*\*.\*

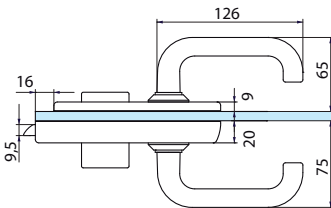
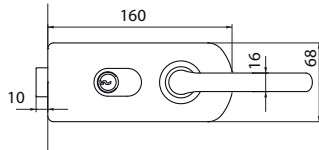
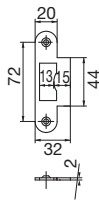
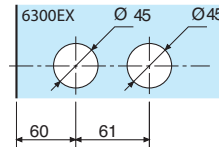

References

Lock with euro profile cylinder, pair of handles and cylinder cover



Polished brass PVD

Bright chromium

Matt chromium

Stainless steel effect

Lacquered white RAL 9010

4550.05.0

4550.30.0

4550.31.0

4550.35.0

4550.51.0



4550.05.4

4550.30.4

4550.31.4

4550.35.4

4550.51.4



4550.05.5

4550.30.5

4550.31.5

4550.35.5

4550.51.5

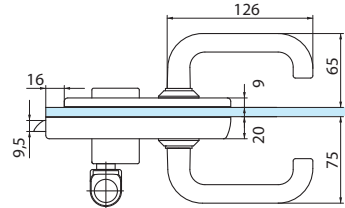
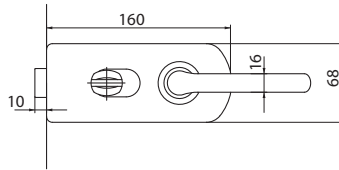
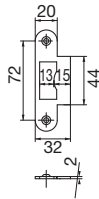
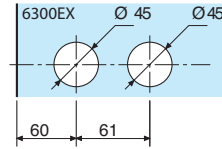

4555.\*\*.0



References

Lock with thumb turn cylinder,  
pair of handles and cylinder cover



	Polished brass PVD	Bright chromium	Matt chromium	Stainless steel effect	Lacquered white RAL 9010
	4555.05.0	4555.30.0	4555.31.0	4555.35.0	4555.51.0
	4555.05.4	4555.30.4	4555.31.4	4555.35.4	4555.51.4
	4555.05.5	4555.30.5	4555.31.5	4555.35.5	4555.51.5

4509

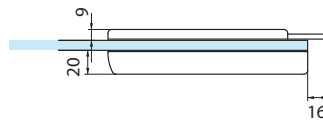
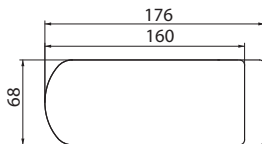
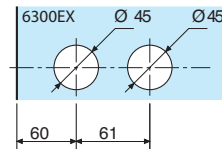

References



	Polished brass PVD	Bright chromium	Matt chromium	Stainless steel effect	Lacquered white RAL 9010
	4509.05.0	4509.30.0	4509.31.0	4509.35.0	4509.51.0

Matching patch keep  
for locks series 4500