

Door Rails V850/V870/V880 - Pivoting Doors

Série V850 / V870 / V880

Technical features

- Height 100 mm
- For 8, 10 and 12mm thick glass
- No notches needed
- Maximum door weight 80, 100 kg
- Maximum door size 1400 x 2400 mm

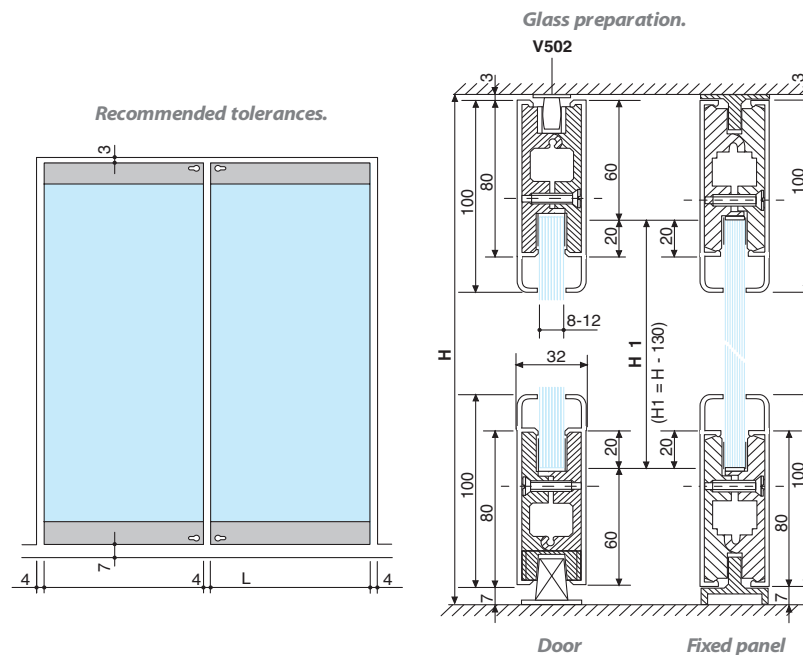

PREFIT

FITTINGS FOR GLASS

V850/V870/V880 - Pivoting Doors

V850

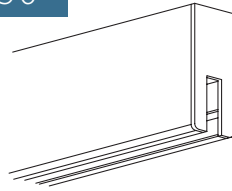

References

Top rail 100 mm high with cover plates, pivot block and end caps

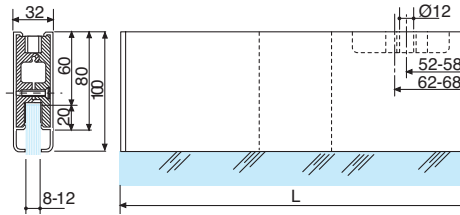

 For 8 mm glass	V850/08.12	V850/08.15	V850/08.36
 For 10 mm glass	V850/10.12	V850/10.15	V850/10.36
 For 12 mm glass	V850/12.12	V850/12.15	V850/12.36

V851

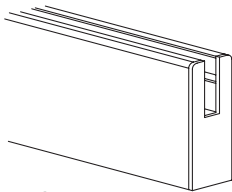

References

D Bottom rail 100 mm high with cover plates, with German insert block and end caps

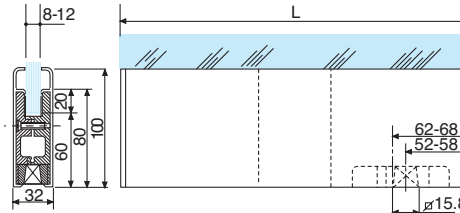

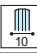
 For 8 mm glass	V851/08.12	V851/08.15	V851/08.36
 For 10 mm glass	V851/10.12	V851/10.15	V851/10.36
 For 12 mm glass	V851/12.12	V851/12.15	V851/12.36

V852

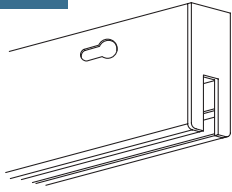

References

Top rail 100 mm high with cover plates, pivot block, end caps and lock with cylinder

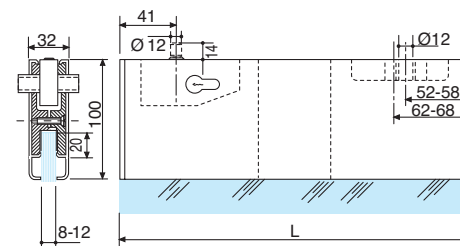

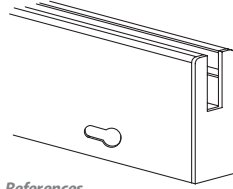

 For 8 mm glass	V852/08.12	V852/08.15	V852/08.36
 For 10 mm glass	V852/10.12	V852/10.15	V852/10.36
 For 12 mm glass	V852/12.12	V852/12.15	V852/12.36

V853



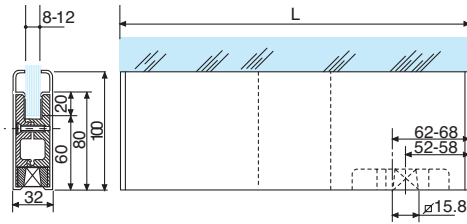

References



D  Bottom rail 100 mm high with cover plates, pivot block, end caps and lock with cylinder



	For 8 mm glass	V853/08.12	V853/08.15	V853/08.36
	For 10 mm glass	V853/10.12	V853/10.15	V853/10.36
	For 12 mm glass	V853/12.12	V853/12.15	V853/12.36

V854

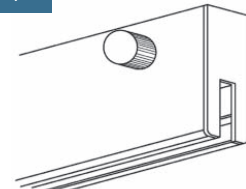

References

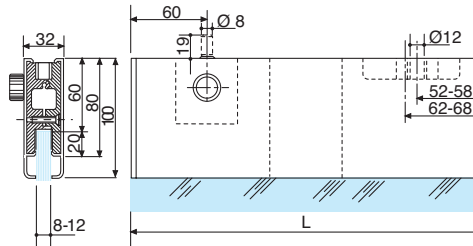

Top rail 100 mm high with cover plates, pivot block, end caps and thumb turn lock



	For 8 mm glass	V854/08.12	V854/08.15	V854/08.36
	For 10 mm glass	V854/10.12	V854/10.15	V854/10.36
	For 12 mm glass	V854/12.12	V854/12.15	V854/12.36

V855

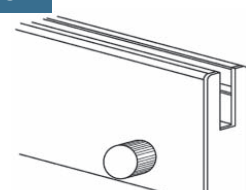

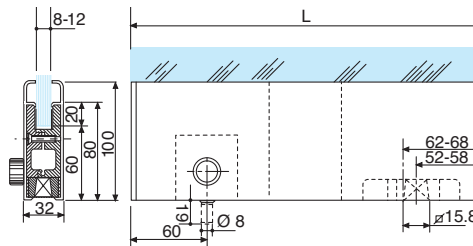

References

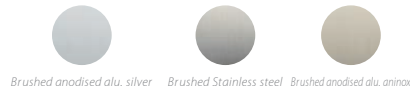

D  Bottom rail 100 mm high with cover plates with pivot block, end caps and thumb turn lock



	For 8 mm glass	V855/08.12	V855/08.15	V855/08.36
	For 10 mm glass	V855/10.12	V855/10.15	V855/10.36
	For 12 mm glass	V855/12.12	V855/12.15	V855/12.36

V870

References

Top rail 100 mm high 52 mm offset DIN Left with cover plates and end caps

Brushed anodised alu. silver Brushed Stainless steel Brushed anodised alu. aninox

 For 8 mm glass	V870/08.12	V870/08.15	V870/08.36
 For 10 mm glass	V870/10.12	V870/10.15	V870/10.36
 For 12 mm glass	V870/12.12	V870/12.15	V870/12.36

V871

References

Bottom rail 100 mm high 52 mm offset DIN Left with cover plates and end caps

Brushed anodised alu. silver Brushed Stainless steel Brushed anodised alu. aninox

 For 8 mm glass	V871/08.12	V871/08.15	V871/08.36
 For 10 mm glass	V871/10.12	V871/10.15	V871/10.36
 For 12 mm glass	V871/12.12	V871/12.15	V871/12.36

V880

References

Top rail 100 mm high 52 mm offset DIN Right with cover plates and end caps

Brushed anodised alu. silver Brushed Stainless steel Brushed anodised alu. aninox

 For 8 mm glass	V880/08.12	V880/08.15	V880/08.36
 For 10 mm glass	V880/10.12	V880/10.15	V880/10.36
 For 12 mm glass	V880/12.12	V880/12.15	V880/12.36

V881

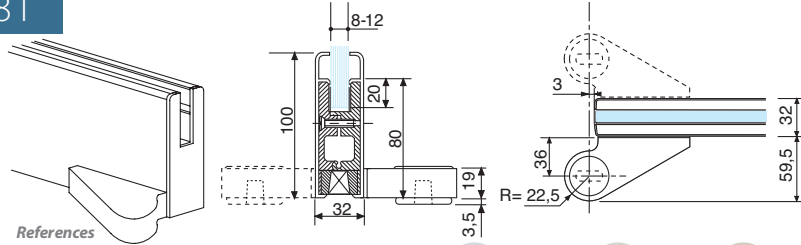

References



Bottom rail 100 mm high 52 mm offset DIN Right with cover plates and end caps



For 8 mm glass

V881/08.12 V881/08.15 V881/08.36



For 10 mm glass

V881/10.12 V881/10.15 V881/10.36



For 12 mm glass

V881/12.12 V881/12.15 V881/12.36

V872

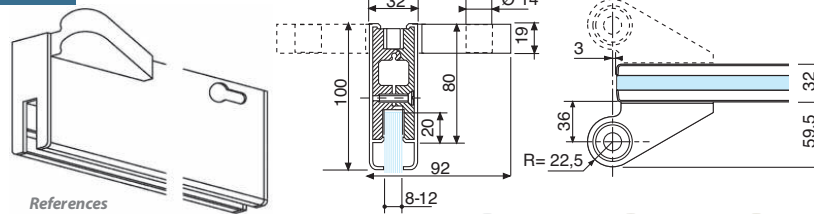

References

Top rail 100 mm high 52 mm offset DIN Left with cover plates, end caps and lock with cylinder



For 8 mm glass

V872/08.12 V872/08.15 V872/08.36



For 10 mm glass

V872/10.12 V872/10.15 V872/10.36



For 12 mm glass

V872/12.12 V872/12.15 V872/12.36

V873

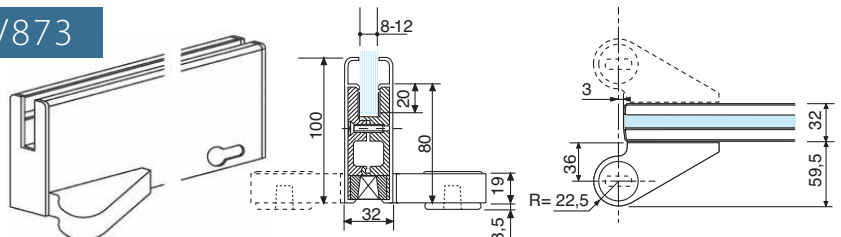

References



Bottom rail 100 mm high 52 mm offset DIN Left with cover plates, end caps and lock with cylinder



For 8 mm glass

V873/08.12 V873/08.15 V873/08.36



For 10 mm glass

V873/10.12 V873/10.15 V873/10.36



For 12 mm glass

V873/12.12 V873/12.15 V873/12.36

V882

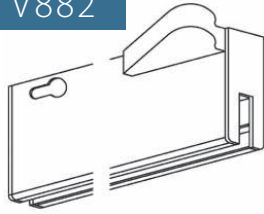

References

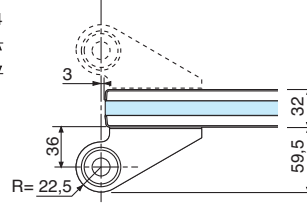
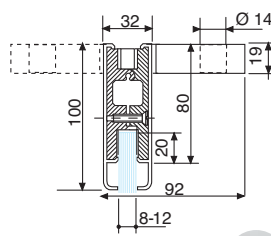

Top rail 100 mm high 52 mm offset DIN Right with cover plates, end caps and lock with cylinder



 For 8 mm glass	V882/08.12	V882/08.15	V882/08.36
 For 10 mm glass	V882/10.12	V882/10.15	V882/10.36
 For 12 mm glass	V882/12.12	V882/12.15	V882/12.36

V883

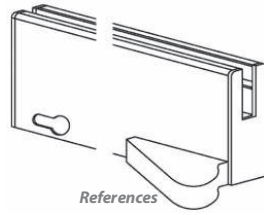

References

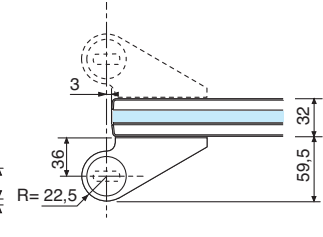
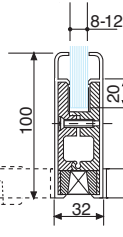

D Bottom rail 100 mm high 52 mm offset DIN Right with cover plates and end caps



 For 8 mm glass	V883/08.12	V883/08.15	V883/08.36
 For 10 mm glass	V883/10.12	V883/10.15	V883/10.36
 For 12 mm glass	V883/12.12	V883/12.15	V883/12.36

V856

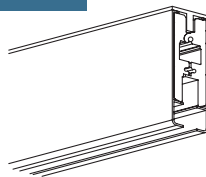

References

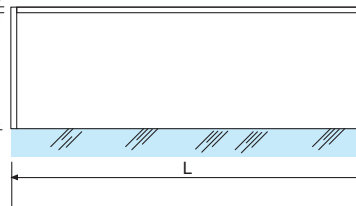
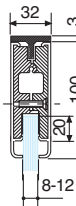

Top rail 100 mm high rail for fixed panels, with covers without end caps + 3 mm Top filler profile



 For 8 mm glass	V856/08.12	V856/08.15	V856/08.36
 For 10 mm glass	V856/10.12	V856/10.15	V856/10.36
 For 12 mm glass	V856/12.12	V856/12.15	V856/12.36

V857

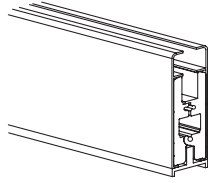

References

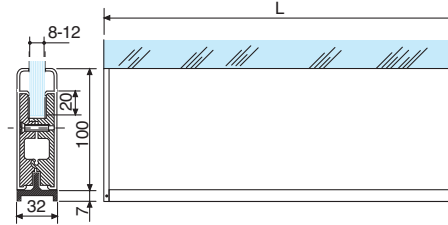

100 mm bottom rail for fixed panels, with covers without end caps + 7 mm bottom filler profile

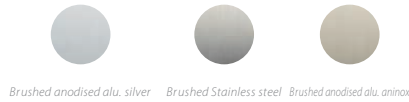

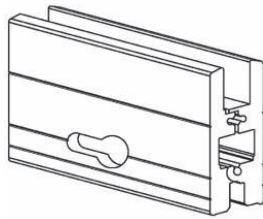

 For 8 mm glass	V857/08.12	V857/08.15	V857/08.36
 For 10 mm glass	V857/10.12	V857/10.15	V857/10.36
 For 12 mm glass	V857/12.12	V857/12.15	V857/12.36

V800MS/**.99

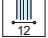

References

 V800 rail lock module for 8mm glass	V800MS/08.99
 V800 rail lock module for 10mm glass	V800MS/10.99
 V800 rail lock module for 10mm glass	V800MS/10.99

V890

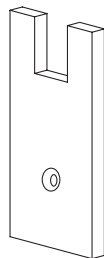

References

Aluminium end cap 80 mm for V800



V890.12 **V890.36**

V893

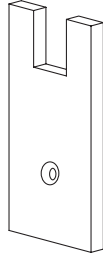

References

Aluminium end cap 83 mm for V800 and fixed panels



Brushed anodised alu. silver



Brushed anodised alu. aninox

V893.12

V893.36

V897

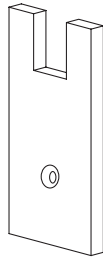

References

Aluminium end cap 87 mm and V800 for fixed panels



Brushed anodised alu. silver



Brushed anodised alu. aninox

V897.12

V897.36

V895

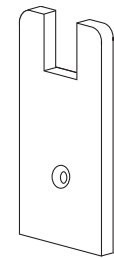

References

Aluminium end cap 100 mm for V850 series



Brushed anodised alu. silver



Brushed anodised alu. aninox

V895.12

V895.36