

## Clipline - Pivoting Doors

### CLIPLINE

**Technical features**

- For 10 and 12 mm thick toughened glass
- Max load 100 kg
- Assembly on notch
- Maximum door width 1250 mm
- Compatible with :
  - Floor springs
  - Pivot

### RECOMMENDED TOLERANCES

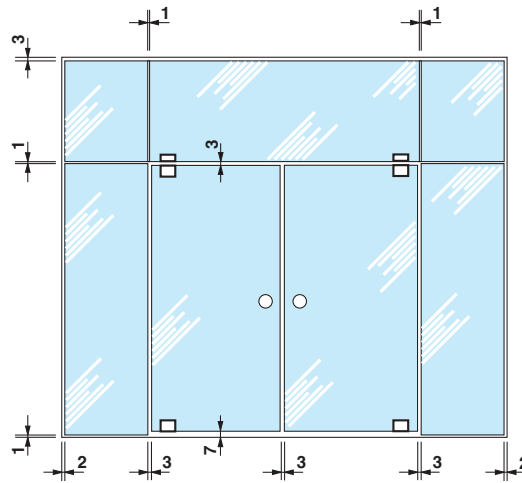

### STANDARD INSTALLATION

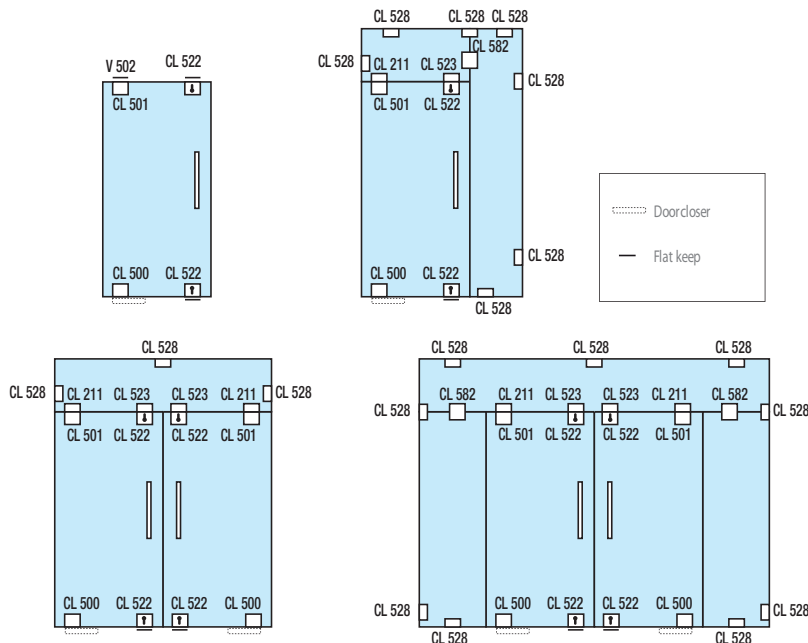

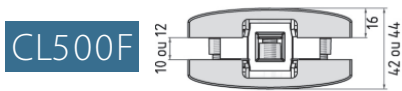
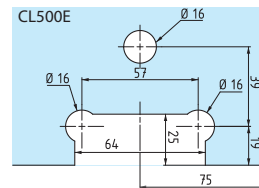
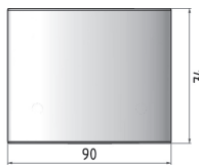
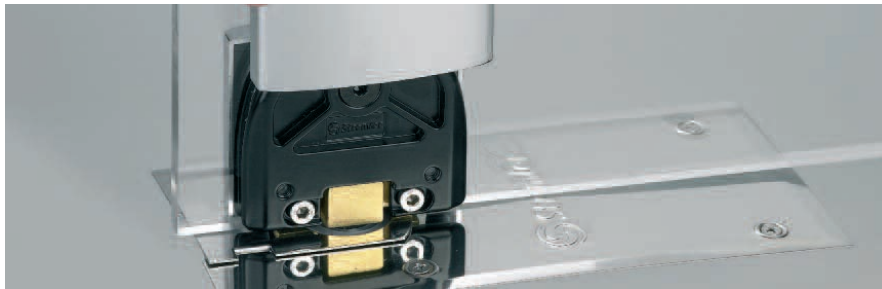

**CL500F**

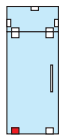

References

Bottom Hinge for French square spindle



Bright chromium    Matt chromium    Stainless steel effect

**CL500F.30**    **CL500F.31**    **CL500F.35**

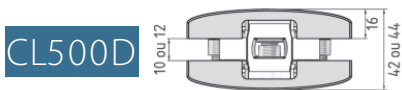

**CL500D**

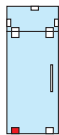

References

Bottom Hinge for German rectangular spindle



Bright chromium    Matt chromium    Stainless steel effect

**CL500D.30**    **CL500D.31**    **CL500D.35**

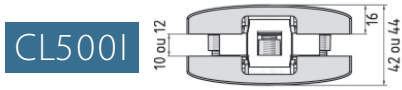

**CL500I**

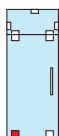

References

Bottom hinge for Italian square spindle



Bright chromium    Matt chromium    Stainless steel effect

**CL500I.30**    **CL500I.31**    **CL500I.35**

## CL501

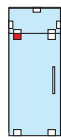
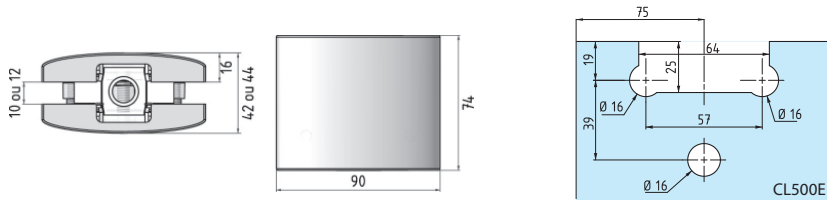

References



Top patch hinge



Bright chromium



Matt chromium



Stainless steel effect

CL501.30

CL501.31

CL501.35

## CL522

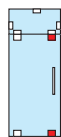
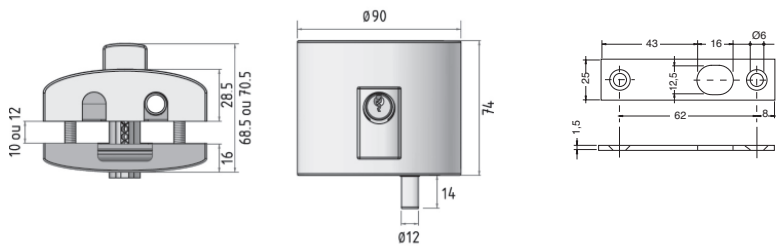
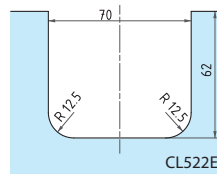

References



Top and bottom lock with cylinder



Bright chromium



Matt chromium



Stainless steel effect

CL522.30

CL522.31

CL522.35

• Supplied with flat keep

## CL523

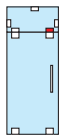
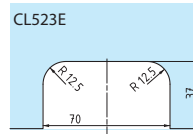
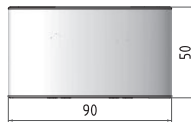
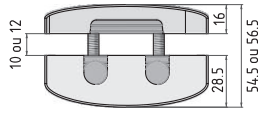

References

Patch keep for lock CL522



Bright chromium



Matt chromium



Stainless steel effect

CL523.30

CL523.31

CL523.35

## CL211

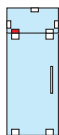
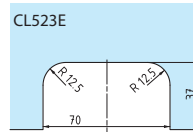
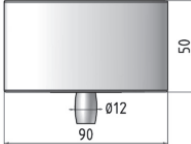

References

Top pivot patch



Bright chromium



Matt chromium



Stainless steel effect

CL211.30

CL211.31

CL211.35

**CL528**

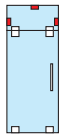
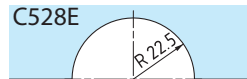
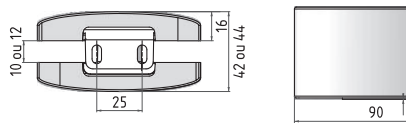

References

Wall to glass partition clip



Bright chromium



Matt chromium



Stainless steel effect

**CL528.30**

**CL528.31**

**CL528.35**

**CL582**

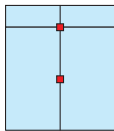
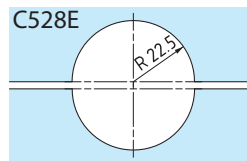
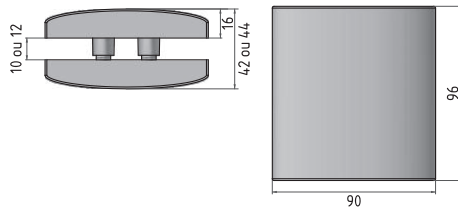

References

Glass to glass partition clip



Bright chromium



Matt chromium



Stainless steel effect

**CL582.30**

**CL582.31**

**CL582.35**

AC299.33

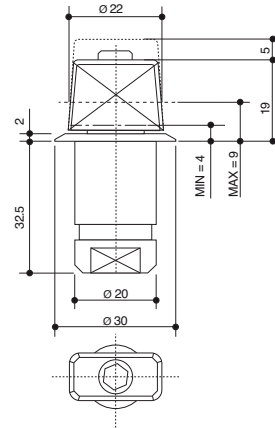

Adjustable German rectangular floor pivot, to be embedded

AC246.33

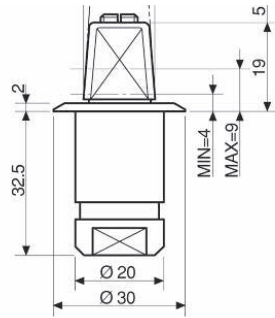

Adjustable Italian square floor pivot, to be embedded

V502

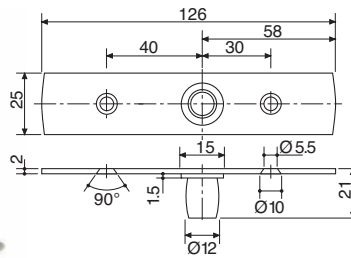

References

Offset top pivot for V501/V201

Stainless steel effect

V502.15