

## Showcase Locks - Shopfitting

1470.\*\*.0

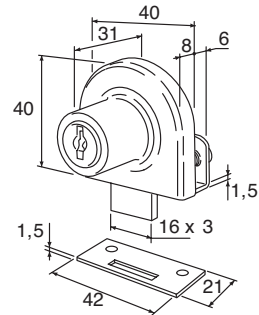

References



Showcase lock without notch



Polished brass

1470.00.0



Bright chromium

1470.30.0

- The key can be removed in locked and unlocked position
- Locks may be supplied on same number
- May be combined with showcase locks series 1471 / 1476
- Tightened with 2 tipped screws
- Supplied with 2 keys and 1 flat keep

1479.\*\*.0

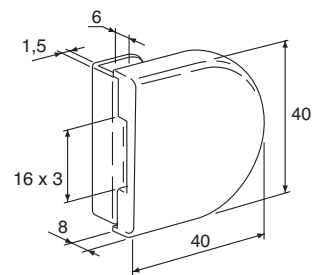

References



Patch keep without notch for 1470 lock



Polished brass

1479.00.0



Bright chromium

1479.30.0

- Tightened with 2 tipped screws

1471.\*\*.0

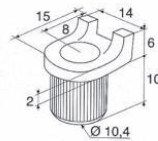
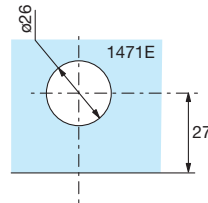
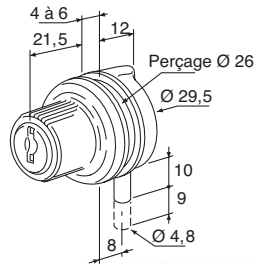

References



Lock for swing door



Polished brass



Bright chromium

**1471.00.0**

**1471.30.0**

- For notch 1471E
- The key can be removed in locked and unlocked position
- Locks may be supplied on same number
- May be combined with showcase locks series 1470 / 1476
- Supplied with 2 keys and 1 keep

1476.\*\*.\*

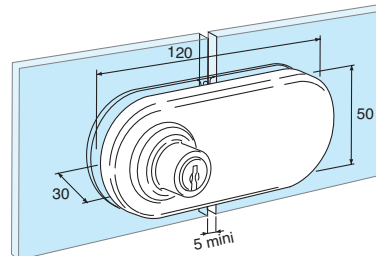

References

Showcase lock for double doors



Polished brass



Bright chromium



Matt chromium

**1476.00.2**

**1476.30.2**

**1476.31.2**

**1476.00.3**

**1476.30.3**

**1476.31.3**

- Simultaneous locking of 2 glass doors with one lock
- For 6 or 8 mm thick toughened glass
- No notch required
- The key can be removed in locked and unlocked position
- Locks may be supplied on same number
- May be combined with showcase locks series 1470 / 1471
- Fixes with self-adhesive band
- Supplied with 2 keys

1450.\*\*.0

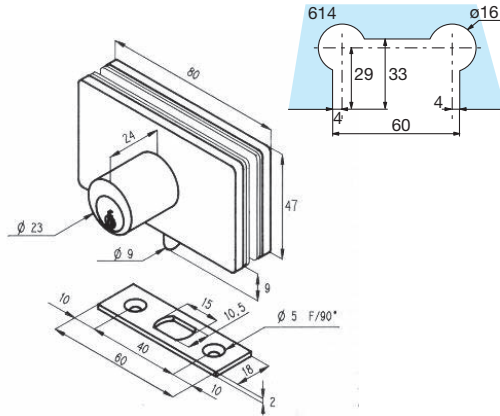

References



Showcase lock



Bright chromium    Matt chromium    Gold plated

**1450.30.0**    **1450.31.0**    **1450.40.0**

- Lock fitted with beveled spring bolt
- For notch 614
- Lock with captive key
- Door locks when pushed shut without use of key, self retracting bolt
- May be fitted in accordance with key chart and on same number
- Supplied with 3 keys and a flat keep

1452.\*\*.0

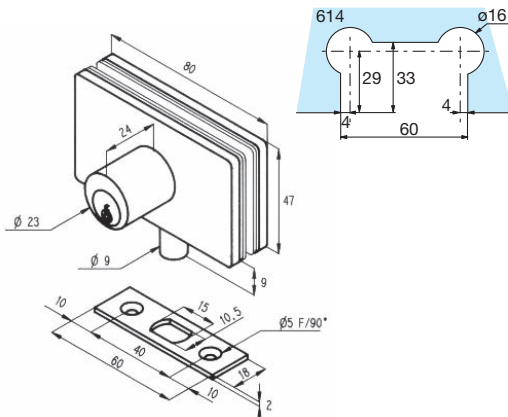

References



Showcase lock



Bright chromium    Matt chromium    Gold plated

**1452.30.0**    **1452.31.0**    **1452.40.0**

- Lock with round spring bolt
- For notch 614
- Lock with captive key
- Door locks with key
- May be fitted in accordance with key chart and on same number
- Supplied with 3 keys and a flat keep

1453.\*\*.0

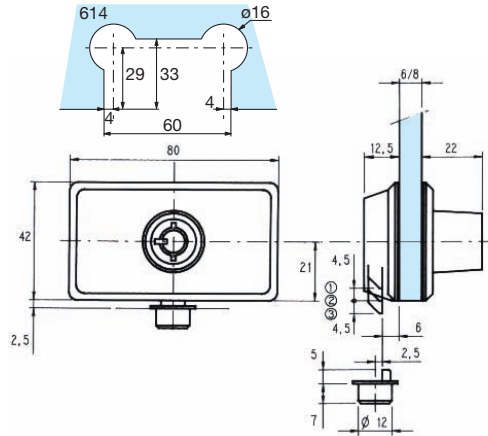

References



Showcase lock



1453.30.0      1453.31.0      1453.40.0

- For notch 614
- 3 key positions
- 1 – Completely retracted bolt
- 2 – Self retracting bolt in intermediary position
- 3 – Bolt blocked in locked position
- 10 000 combinations radial pin cylinder

- Locks may be supplied on same key number
- Key may be supplied with number corresponding to drawer locks 1457 and 1456
- Key can be withdrawn at all positions
- Supplied with 2 keys and a cylindrical keep stop

1456.\*\*.0

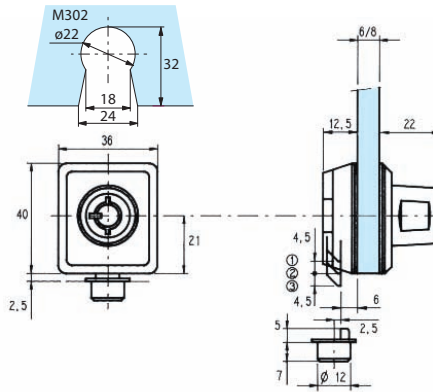

References



Showcase lock



1456.30.0      1456.31.0      1456.40.0

Lock with captive key

1456.30.OP      1456.31.OP      1456.40.OP

- For notch M302 or 22 mm  $\phi$  hole
- 3 key positions
- 1 – Completely retracted bolt
- 2 – Self retracting bolt in intermediary position
- 3 – Bolt blocked in locked position
- 10 000 combinations radial pin cylinder

- Locks may be supplied on same key number
- Key may be supplied with number corresponding to locks 1457 and 1453
- Key can be withdrawn at all positions
- Supplied with 2 keys and a cylindrical keep stop

1455.\*\*.0

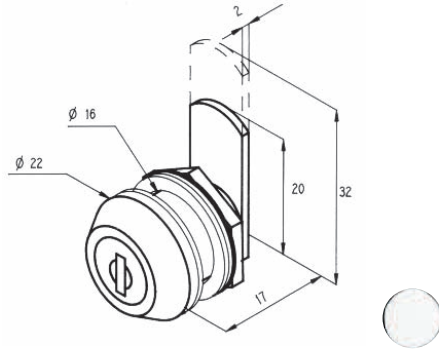

References



Cam showcase locks

Bright chromium

1455.30.0

- Fixes onto 17 mm Ø hole
- Locks and unlocks with key
- Key removed in locked or unlocked position
- Equipped with 200 combination pin-tumbler cylinder
- Locks may be supplied on same number
- May be combined with showcase lock series 1454
- Supplied with 2 keys and a 20 mm and 32 mm long cam (cylinder axis)
- Position of hole's axis from the edge of the glass =  
Cam length – space between the end of the door and the showcase frame – length of cam's entry into the frame

1457.\*\*.0

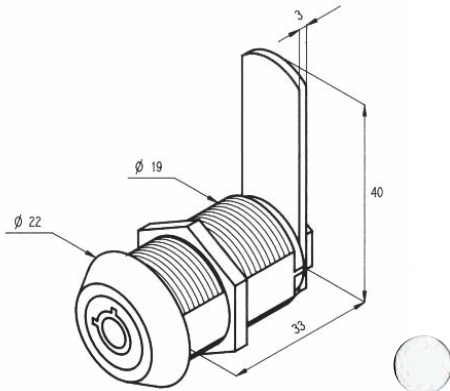
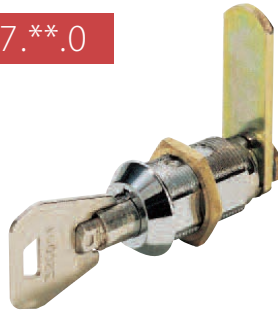

References

Cam showcase locks

Bright chromium

1457.30.0

- For drawer 22 mm thick maximum
- Fixes onto 19 mm Ø hole
- Locks and unlocks with key
- Key may be removed in locked and or unlocked position
- 10 000 combination radial piston cylinder
- Locks may be supplied on same number
- May be combined with showcase lock series 1456 and 1453
- Supplied with 2 keys and a 40 mm long cam (from cylinder axis)

1454.\*\*.0

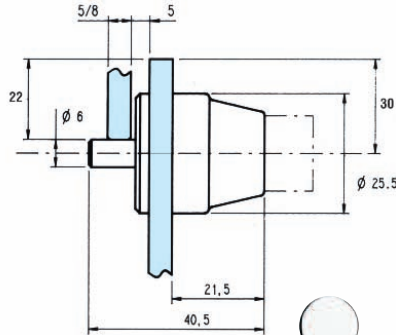

References



Push button lock

Bright chromium

Gold plated

1454.30.0

1454.40.0

- Fixes onto 22 mm Ø hole to 30 mm minimum from edge of glass
- Overlap on glass 22 mm
- 5 mm play between panels
- Unlocks with key in push button keyhole
- Locks by simple pressure on push button
- Locks may be supplied on same number
- May be combined with showcase lock series 1455
- Supplied with 2 keys

1459.\*\*.0

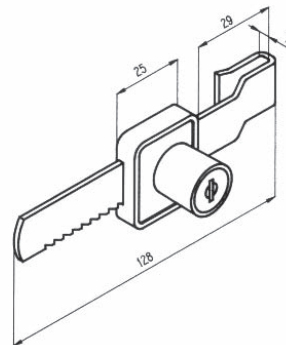
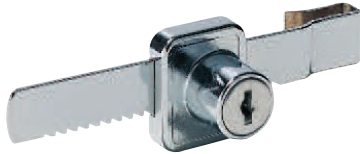

References



Ratchet

Bright chromium

1459.30.0

- Fixes onto 22 mm Ø hole to 30 mm minimum from edge of glass
- Overlap on glass 22 mm
- 5 mm play between panels
- Unlocks with key in push button keyhole
- Locks by simple pressure on push button
- Locks may be supplied on same number
- May be combined with showcase lock series 1455
- Supplied with 2 keys

1460.\*\*.0



References



Security lock with spring bolt beveled

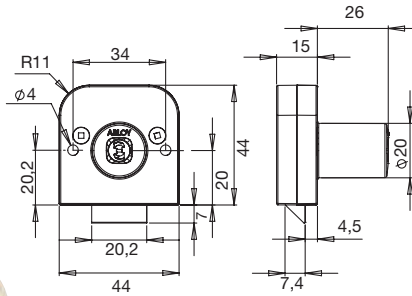

Bright chromium

1460.30.0

- For wood or particle board, max 20 mm thick
- Fits onto Ø 23 mm hole
- Function with or without captive key
- Reversible key
- Security cylinder with rotary disc
- Locks may be supplied : - on same number  
- on key chart  
- number of keys to be indicated when ordering
- May be combined with locks series  
1461, 1462, 1463, 1464, 1465, 1466, 1467, 1468
- Supplied with 1 flat keep, 1 rosace, 2 keys

1462.\*\*.0



References



Security lock with dead bolt

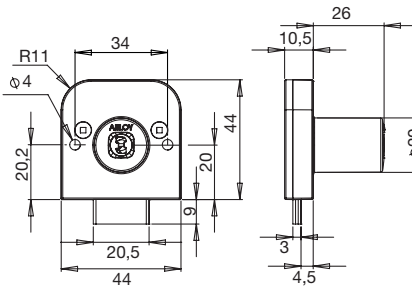

Bright chromium

1462.30.0

- For wood or particle board, max 20 mm thick
- Fits onto Ø 23 mm hole
- Function with or without captive key
- Reversible key
- Security cylinder with rotary disc
- Locks may be supplied : - on same number  
- on key chart  
- number of keys to be indicated when ordering
- May be combined with locks series  
1461, 1462, 1463, 1464, 1465, 1466, 1467, 1468
- Supplied with 1 flat keep, 1 rosace, 2 keys

1462.\*\*.0C

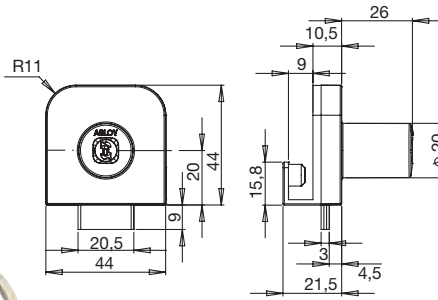

References



Security lock with dead bolt



Bright chromium

1462.30.0C

- No notch required
- Function with or without captive key
- Reversible key
- Security cylinder with rotary disc
- Locks may be supplied:
  - on same number
  - on key chart
  - number of keys to be indicated when ordering
- May be combined with locks series 1460, 1461, 1463, 1464, 1465, 1466, 1467, 1468
- Supplied with 1 flat keep, 1 rosace, 2 keys



1464.\*\*.0

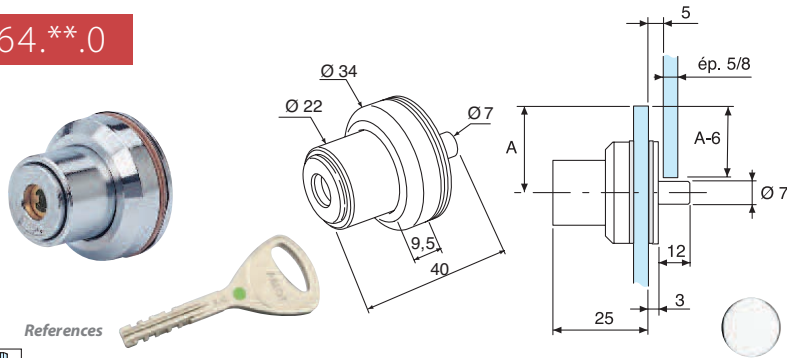

Security push button lock

Bright chromium

1464.30.0

- Fits onto Ø 30 mm hole (hole axis at 25 mm from the edge)
- Unlocking with the key
- Reversible key
- Locking with the push button
- Doors overlap A – 6 mm
- Space between the doors 5 mm
- A = Position of the hole from the edge of the glass
- Security cylinder with rotary disc
- Locks may be supplied: - on same number  
- on key chart
- Number of keys to be indicated when ordering
- May be combined with locks series  
1460, 1461, 1462, 1463, 1465, 1466, 1467, 1468
- Supplied with 2 keys

1466.\*\*.0

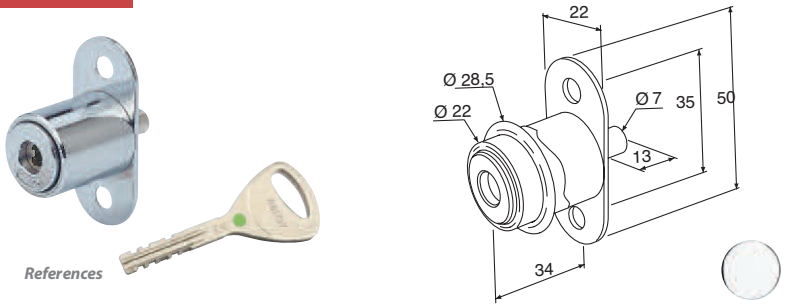

Security push button lock

Bright chromium

1466.30.0

- For wood or particle board, max 33 mm thick
- Fits onto Ø 23 mm hole
- Unlocking with the key
- Reversible key
- Locking by pressing push button
- Security cylinder with rotary disc
- Locks may be supplied: - on same number  
- on key chart
- Number of keys to be indicated when ordering
- May be combined with locks series  
1460, 1461, 1462, 1463, 1464, 1465, 1467, 1468
- Supplied with 1 key, 2 keys

1465.\*\*.0

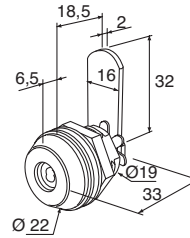

References



Security cam lock



Bright chromium

1465.30.0

- Fits onto Ø 20 mm hole
- Lock with captive key
- Reversible key
- Security cylinder with rotary disc
- Locks may be supplied : - on same number  
- on key chart
- Number of keys to be indicated when ordering
- May be combined with locks series  
1460, 1461, 1462, 1463, 1464, 1466, 1467, 1468
- Supplied with 2 keys, 1 cam 32 mm long (from the cylinder axis).

1467.\*\*.0

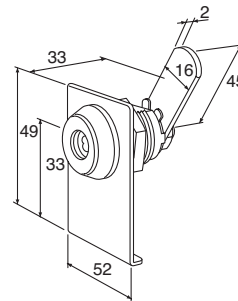

References



Security cam lock



Bright chromium

1467.30.0

- Fits onto Ø 20 mm hole
- Lock with captive key
- Reversible key
- Security cylinder with rotary disc
- Locks may be supplied : - on same number  
- on key chart
- Number of keys to be indicated when ordering
- May be combined with locks series  
1460, 1461, 1462, 1463, 1464, 1465, 1466, 1468
- Supplied with 2 keys, 1 cam 45 mm long (from the cylinder axis)
- Projection of the cam 12 mm

1461.\*\*.0

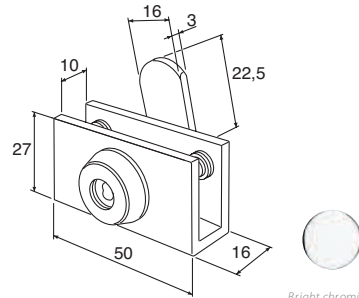
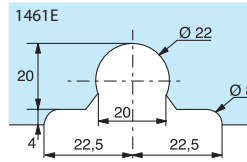

References



Security cam lock

Bright chromium

1461.30.0

- For notch 1461E
- Lock with captive key
- Reversible key
- Security cylinder with rotary disc
- Locks may be supplied: - on same number  
- on key chart
- Number of keys to be indicated when ordering
- May be combined with locks series  
1460, 1461, 1462, 1463, 1464, 1465, 1466, 1467, 1468
- Supplied with 2 keys, 1 cam 22.5 mm long (from the cylinder axis),
- Projection of the cam 9 mm

1463.\*\*.0

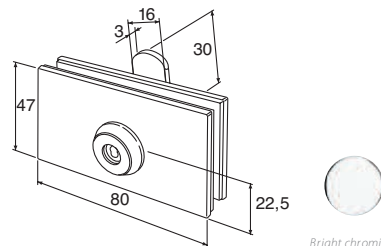
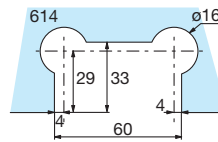

References



Security cam lock

Bright chromium

1463.30.0

- For notch 614
- Lock with captive key
- Reversible key
- Security cylinder with rotary disc
- Locks may be supplied: - on same number  
- on key chart
- Number of keys to be indicated when ordering
- May be combined with locks series  
1460, 1461, 1462, 1464, 1465, 1466, 1467, 1468
- Supplied with 2 keys, 1 cam 30 mm long (from the cylinder axis)
- Projection of the cam 7.5 mm



1468.\*\*.0

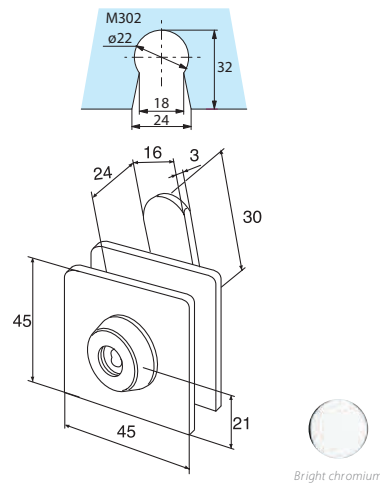

References



Security cam lock

**1468.30.0**

- For notch M302
- Lock with captive key
- Reversible key
- Security cylinder with rotary disc
- Locks may be supplied : - on same number  
- on key chart
- Number of keys to be indicated when ordering
- May be combined with locks series  
1460, 1461, 1462, 1463, 1464, 1465, 1466, 1467
- Supplied with 2 keys, 1 cam 30 mm long (from the cylinder axis),
- Projection of the cam 9 mm