

Steel Spacer Standards - Shopfitting

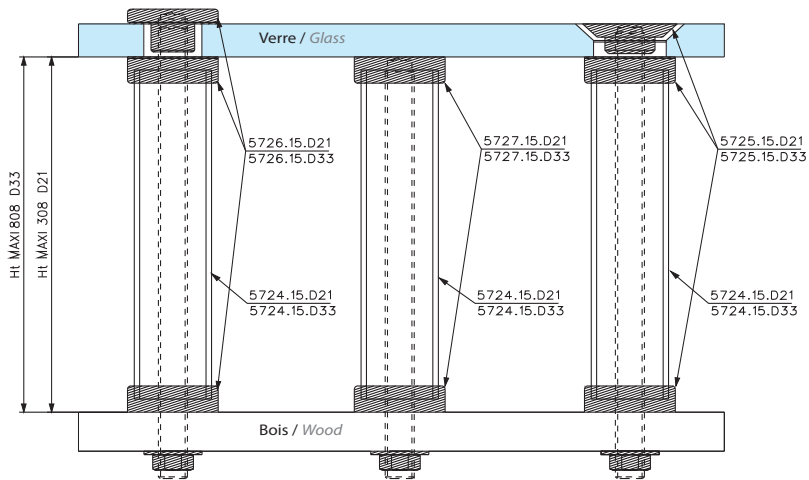

5724.15.D21

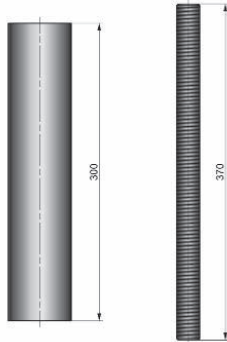

21 mm Ø 300 mm long stainless steel tube with M8 threaded rod

5725.15.D21

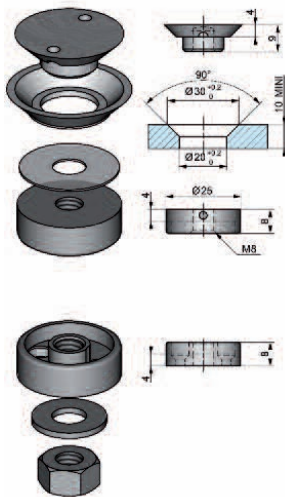

Top and bottom threaded top countersunk head set for 21 mm Ø tube

5726.15.D21

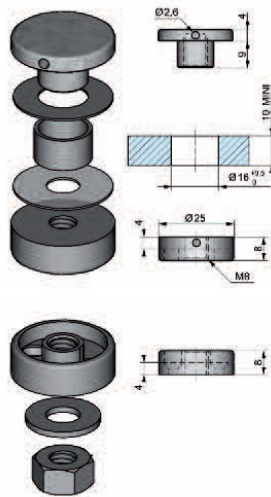

Top and bottom threaded top flat head set for 21 mm Ø tube

5727.15.D21

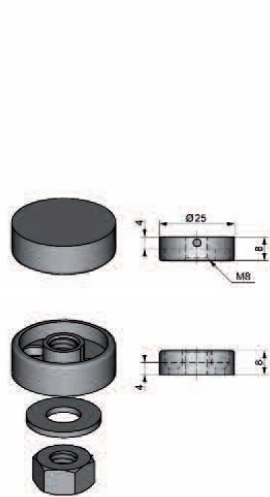

Top and bottom top glued head set for 21 mm Ø tube

• Delivered with tightening wrench

5724.15.D33

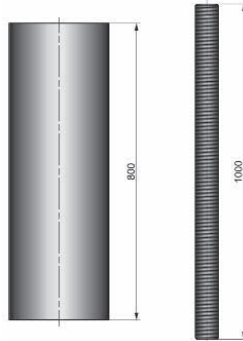

33 mm Ø 300 mm long stainless steel tube with M8 threaded rod

5725.15.D33

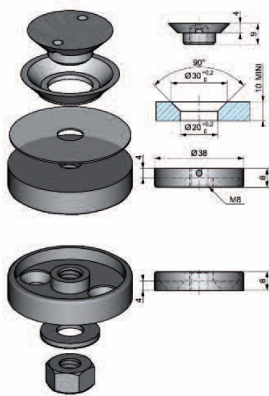

Top and bottom threaded top countersunk head set for 33 mm Ø tube

57 26.5.D33

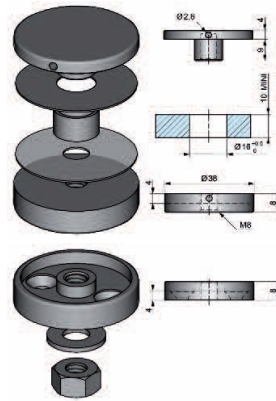

Top and bottom threaded top flat head set for 33 mm Ø tube

5727.15.D33

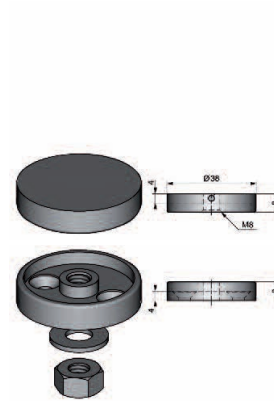

Top and bottom top glued head set for 33 mm Ø tube

• Delivered with tightening wrench

5725.15.0

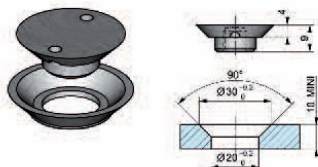

50 stainless steel caps with rings